

### 2-Tiered Leaflet Metal / Acrylic Literature Floor Display Stand (for 8.5 x 11 Magazines, Booklets, and Brochures)

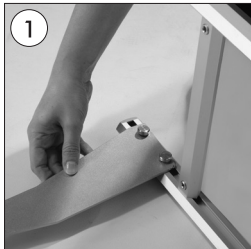

• Screw and fasten the legs on the main body profile of the frame.

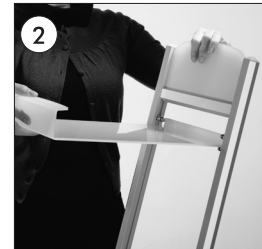
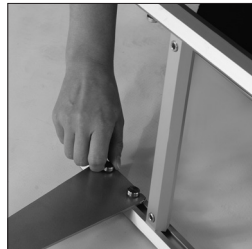

• Put the shelf through main body profile.

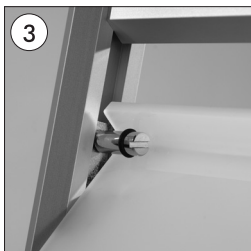

• Fix the short twisted part of the shelf on the edge pins.

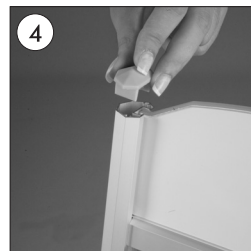

• Take off the end-caps from header part. Slide out 2 pieces of header from profile channels.



• Place your logo between 2 pieces of header. Slide-in the header part from profile channels.

